

# ***Griffith Regional Sports Precinct***

# The Project

- Plan, design & construct a multi-purpose, high quality sports complex for the Western Riverina @ Westend Oval (\$18.8m est)
- A 50M Pool & amenities @ GRALC (\$6m est)
- Develop partnerships with other organisations to deliver a range of outcomes ie PCYC, schools, community and sporting groups

# Features

- 7 indoor courts (usable for Basketball, Volleyball, Badminton, Netball, Futsal etc)
- New kiosk, change rooms, office space, storage and toilets
- 7 outdoor netball courts
- 1 x outdoor Basketball ½ court
- New synthetic Athletic track
- A new artificial turf Hockey pitch
- A new grandstand
- Retain existing Cricket wicket
- New parking and drop off areas

# Locations

## Westend Oval & GRALC

- Council is Trustee therefore controls both of the sites (a key requirement for funding)
- Builds on existing infrastructure to provide best outcome for the community
- Central location for both sites
- Provides best operating cost synergies into the future i.e. whole of life costing efficiencies maximized by operating single sites

# Benefits

- Increase participation in sports in the community & improve pathways for talent
- Reduce need for residents to travel out of town for events
- Attract regional and state sports/other events to the city unlocking sports tourism  
\$\$\$\$\$
- All local schools (secondary & primary) will be major winners

# Now

- Completed Draft Concept Plans – Westend Oval & 50M Pool at GRALC
- Successful in EOI process
- A Sports Precinct Master Plan developed
- Griffith Sports Council members consulted
- In discussion with key partner stakeholders
- Letters of support obtained
- Capital & Operational Budgets prepared
- Preparations underway for Business Case, detailed concept plans & QS (not detailed design yet)



# Communications

- Griffith Sports Council - ongoing
- Community
- PCYC - high level discussion has taken place, interest in the proposal
- NSW Department of Education - both local and state level, ongoing
- NSW State Government - various departments including Premier & Cabinet, ongoing

# Funding

- NSW State Government – Regional Sports Infrastructure Fund \$10M
- GCC - \$10M plus in-kind support
- PCYC - \$1M ongoing discussion
- Education NSW - \$3.5M ongoing discussion
- Joint Use initiative;  
- r.e. Murrumbidgee Regional High School



# Griffith Sports Precinct Master Plan

Revised 20/2/2018

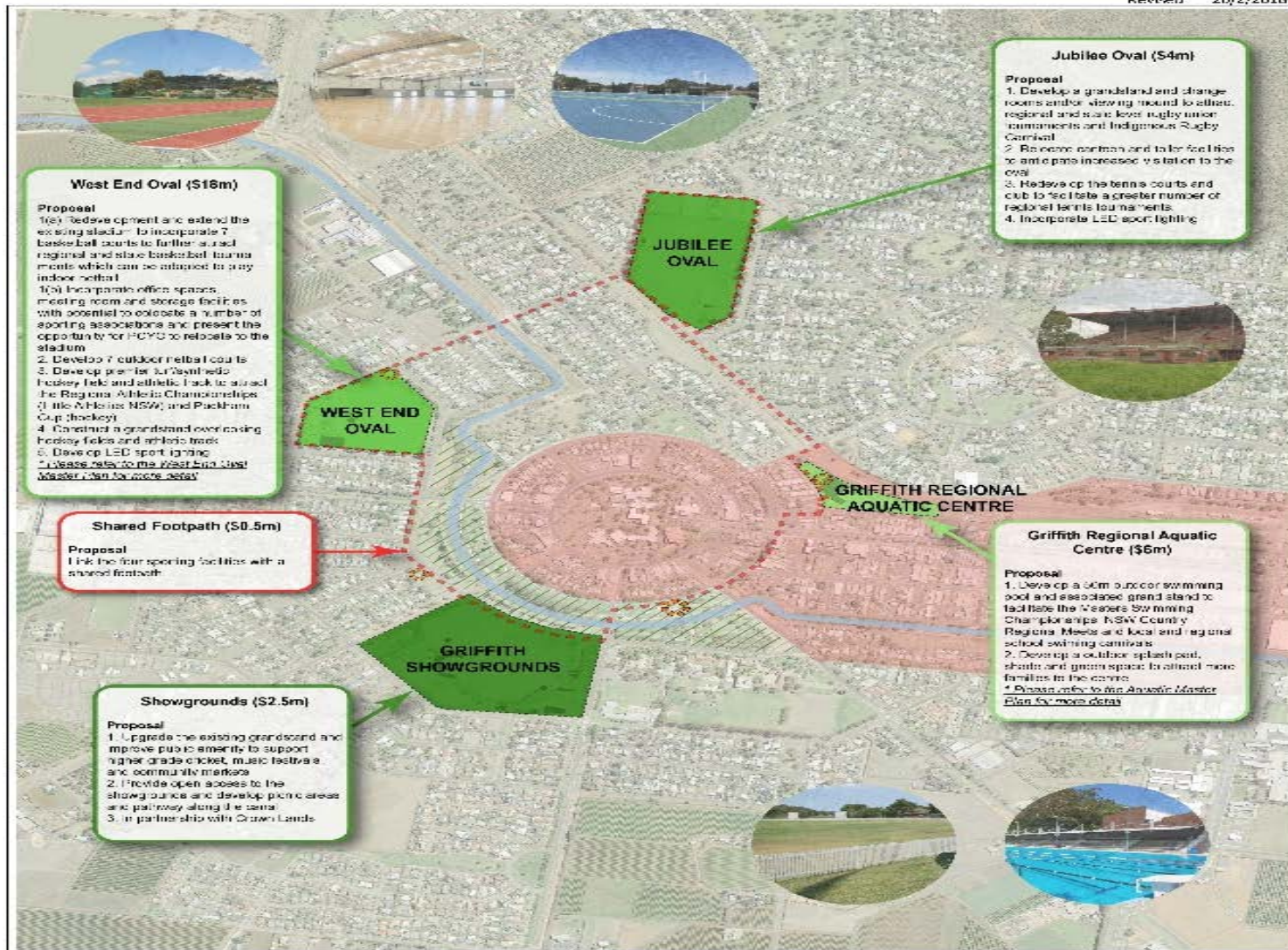

## GRIFFITH SPORTING PRECINCT MASTER PLAN

LEGEND:	
	Shared Pathway
	Playground
	Open Space Network
	City Centre



Version 5 (20 February 2018)

Map Scale: 1:10000 at A3

# Westend Oval Concept Plan

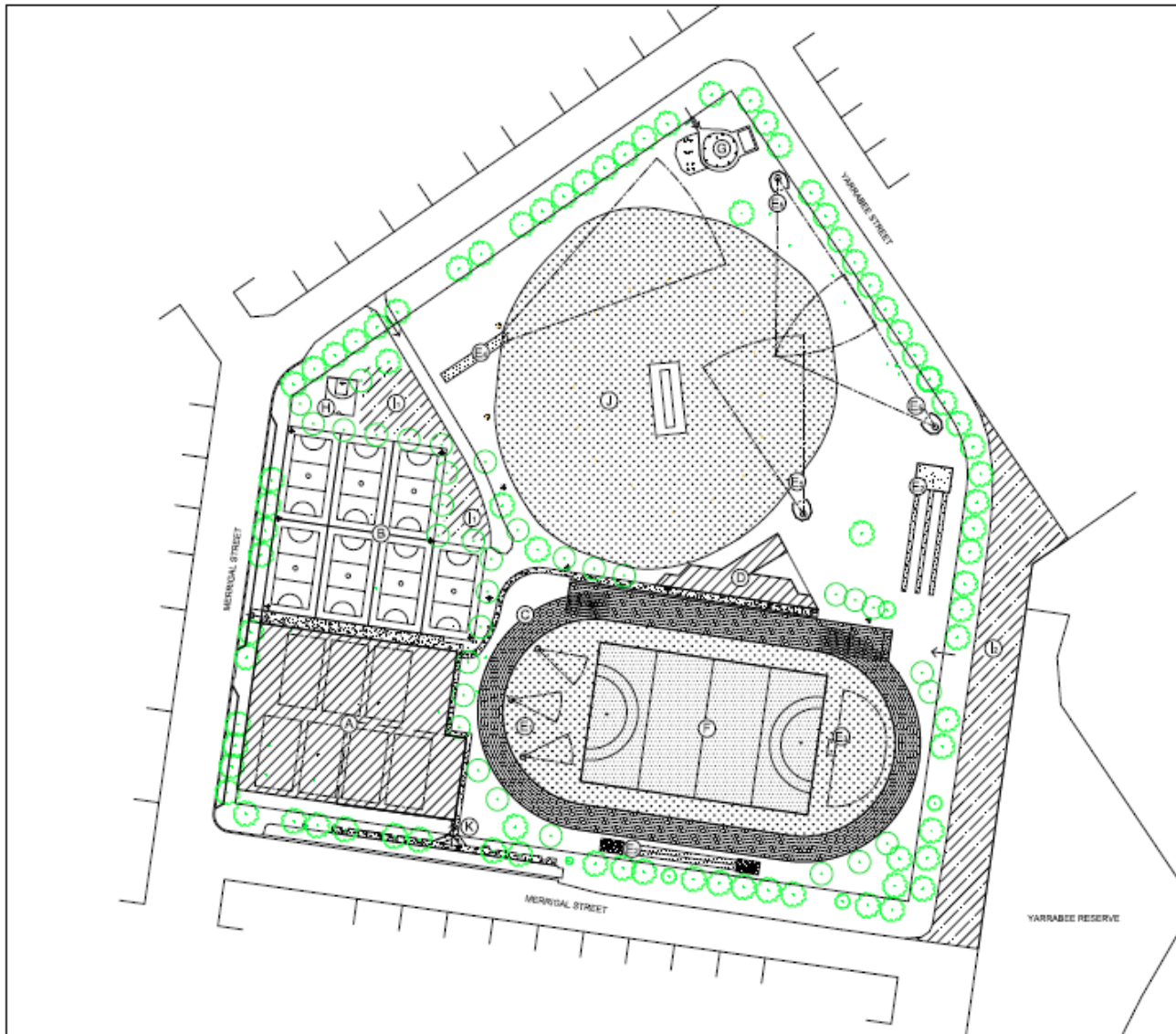

## LEGEND

A	Stadium Expansion
B	Netball Courts (7)
C	ATP(4): Track (synthetic)
D	Grandstand
E	E1, Shot put, E2, Long Jump, E3, High Jump, E4, Javelin, E5, Disc
F	Hockey Field (synthetic)
G	Predict Playground (existing)
H	Half Court Basketball
I	Car Parking
J	Cricket Oval (existing)
K	Entrance Treatment

### NOTE:

The West End Oval Master Plan requires the demolition of the existing building, Parks & Gardens Dept, Council-owned residences and removal of existing trees on the West End Oval.

No.	Rev/Issue	Date
1	A-169-01	1/12/17
2	A-169-02	1/12/2017
3	A-169-03	1/22/2018

## WEST END OVAL MASTER PLAN

Location: West End Oval, Merrigal Street

Scale: 1:1500 @ A3 Drawn By: MJF (JDS/P)

Date: 1 February 2018 Check By:

Sheet No: A-169-02





# Westend Oval Concept Plan

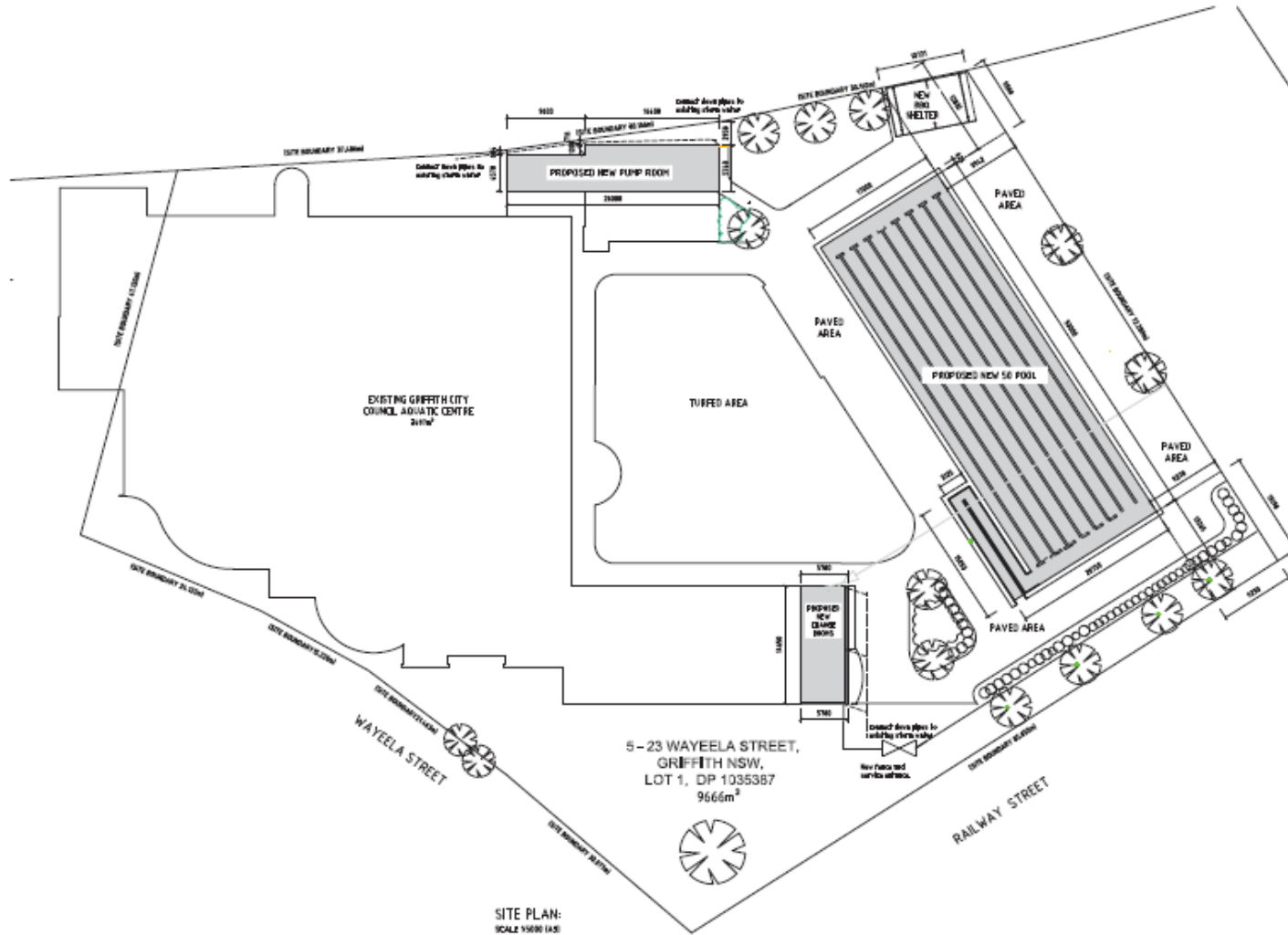

SITE PLAN:  
SCALE 1:500 (A3)

AREAS	AREA
PAVED AREAS	1047
TURF AREAS	1047
WATER	1047
OTHER	1047

**LEGEND**

10	WATER METER
15	NEW METER
20	MANHOLE
25	JOINT BOX

NORTH

DATE	12/10/18
SCALE	1:500



**GRIFFITH CITY COUNCIL**

PROJECT:  
DEMOLITION OF EXISTING SKATE PARK  
AND PROPOSED NEW 50 METER POOL,  
CHANGE ROOMS AND PUMP ROOM AT  
GRALC

<b>SITE PLAN</b>	
DATE	12/10/18
SCALE	1:500
PROJECT	DEMOLITION OF EXISTING SKATE PARK AND PROPOSED NEW 50 METER POOL, CHANGE ROOMS AND PUMP ROOM AT GRALC
DESIGNER	GRALC
CHECKED	01_A02
NO. OF SHEETS	2

**FOR APPROVAL**

# Considerations

- Closure of part of Yarrabee Street, essential for expanded bus drop off & parking requirements
- Disruption to sports at Westend Oval during construction
- Demolition of old skatepark to enable 50M Pool - new one already in place
- GRALC Carparking:
  - 77 spaces in Couchman's Carpark
  - 54 spaces in GRALC Carpark
  - Potential for more parking in Olympic Street

# Next

- Complete preparation of Business Case, detailed concept plan, QS
- Lodge Business Case by 31/8/2018
- Successful applicants to be announced by 31/12/2018
- Further community consultation to take place to inform preparation of final detailed design for both facilities
- Project to be completed by 3 years from execution of funding agreement
- For further information, visit Councils website at [www.Griffith.nsw.gov.au](http://www.Griffith.nsw.gov.au)